

Courses and Dist^{ces} up
Jacobs Creek from post

S. 8. W. - 10.
S. 15. E. 23 1/2
S. 86 E. 16.
S. 73 E. 30.
S. 65 E. 56 1/2
N. 76 E 16
N. 52 E. 54
N. 76 E 9 to post
215

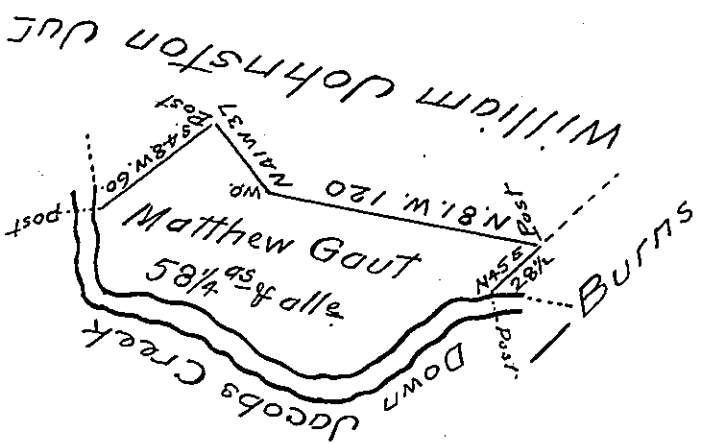

IN PURSUANCE of a warrant bearing date
September 6th 1790 Surveyed December 20th follow-
ing unto Matthew Gaut the above discribed
Tract of Land situate on Jacobs Creek in
Huntington Township Westmoreland County
Containing Fifty Eight 1/4 acres and allow-
ance of six PE Cent &c.

Benj Lodge D.S.

To Daniel Brodhead Esq^r }
Surveyor General - }

IN TESTIMONY that the above is a copy of the original remaining on file in
the Department of Internal Affairs of Pennsylvania, made
conformably to an Act of Assembly approved the 16th day of
February, 1833, I have hereunto set my Hand and caused
the Seal of said Department to be affixed at Harrisburg,
this Twelfth day of October 1904.

John S. Brown
Secretary of Internal Affairs.